



DIY

MADAME LEOTHA







- Clear 3.25" sphere ornament
- 2 1/2" Multi-color LED tea light
- 4" Round wood base
- Black acrylic paint
- Red & gold felt
- Needle & thread
- Black tape & painter's tape
- Frosted glass spray paint
- Printed Madame Leota insert
- Hot glue gun & glue sticks
- Craft knife/scissors
- Foam paint brush
- Needle & thread
- Power drill and 3/4" spade bit

*For candles (optional):*

- 3/16" diameter dowel rod
- Orange & yellow paper







### Prepare the base:

**A.** Mark the center of your 4" wooden base, then use the drill and spade bit to create a 3/4" hole.

**B.** Clean and paint the entire base using two coats of black acrylic paint and a foam brush.



A



B







## Make a tablecloth:

**A.** Take your red felt and cut out a 4" square. Then cut out four 4" x 1/2" pieces of gold felt. These will be for the edges of the tablecloth.

**B.** Glue the gold felt edges flush against all four edges of the red felt.

**C.** Take your scissors and make even cuts halfway up the gold felt. Continue around all four edges.

**D.** Center your wooden base over the tablecloth and trace the 3/4" circle onto the center. Cut out with scissors.

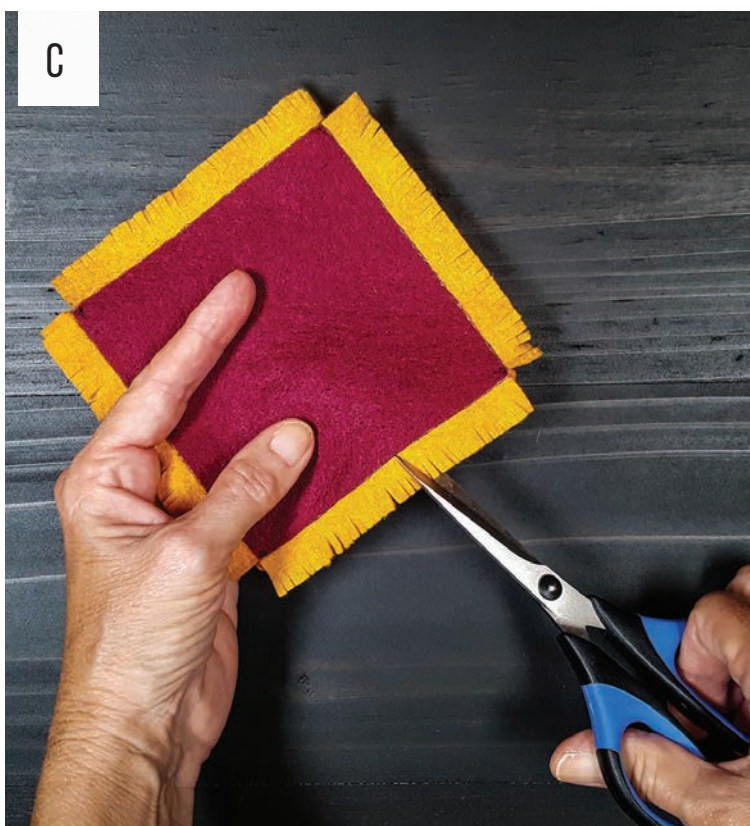
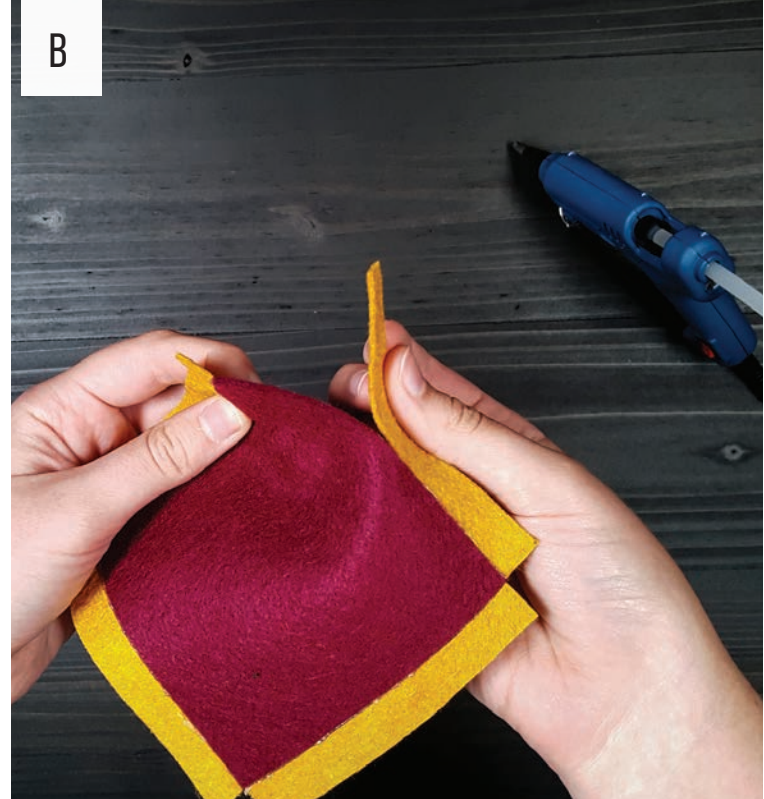
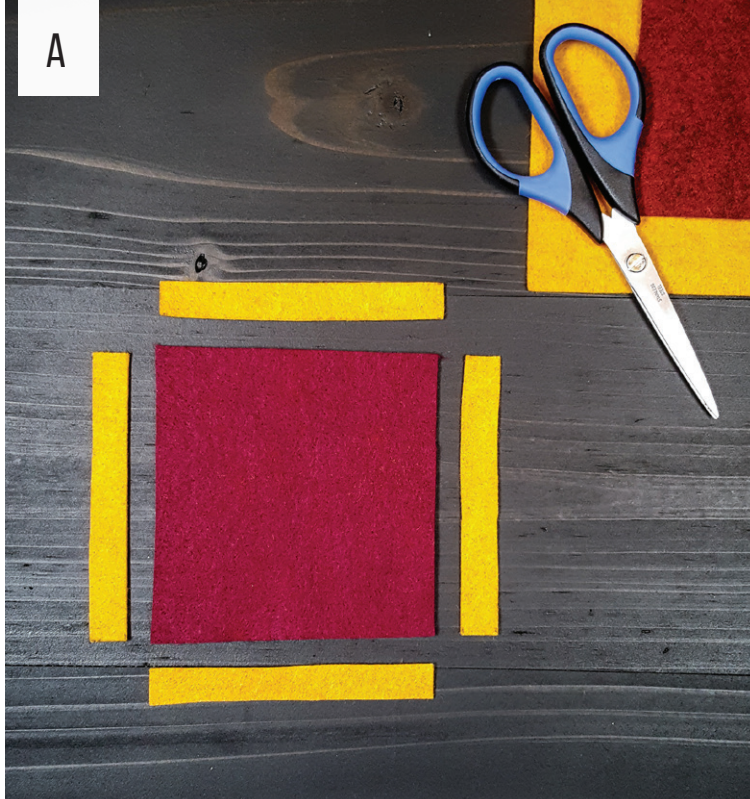





### Create the tassels:

**A.** To make the tassels, cut out four 0.75" x 1.5" pieces of gold felt.

**B.** Take a piece and fold it in half horizontally. Apply a dot of hot glue just below the fold, then pinch the two sides closed.

**C.** Wrap the thread around the middle of the tassel, tie and trim off the excess.

**D.** Use scissors to evenly cut the ends of the tassel. Sew a tassel to each corner of the tablecloth (or use hot glue).

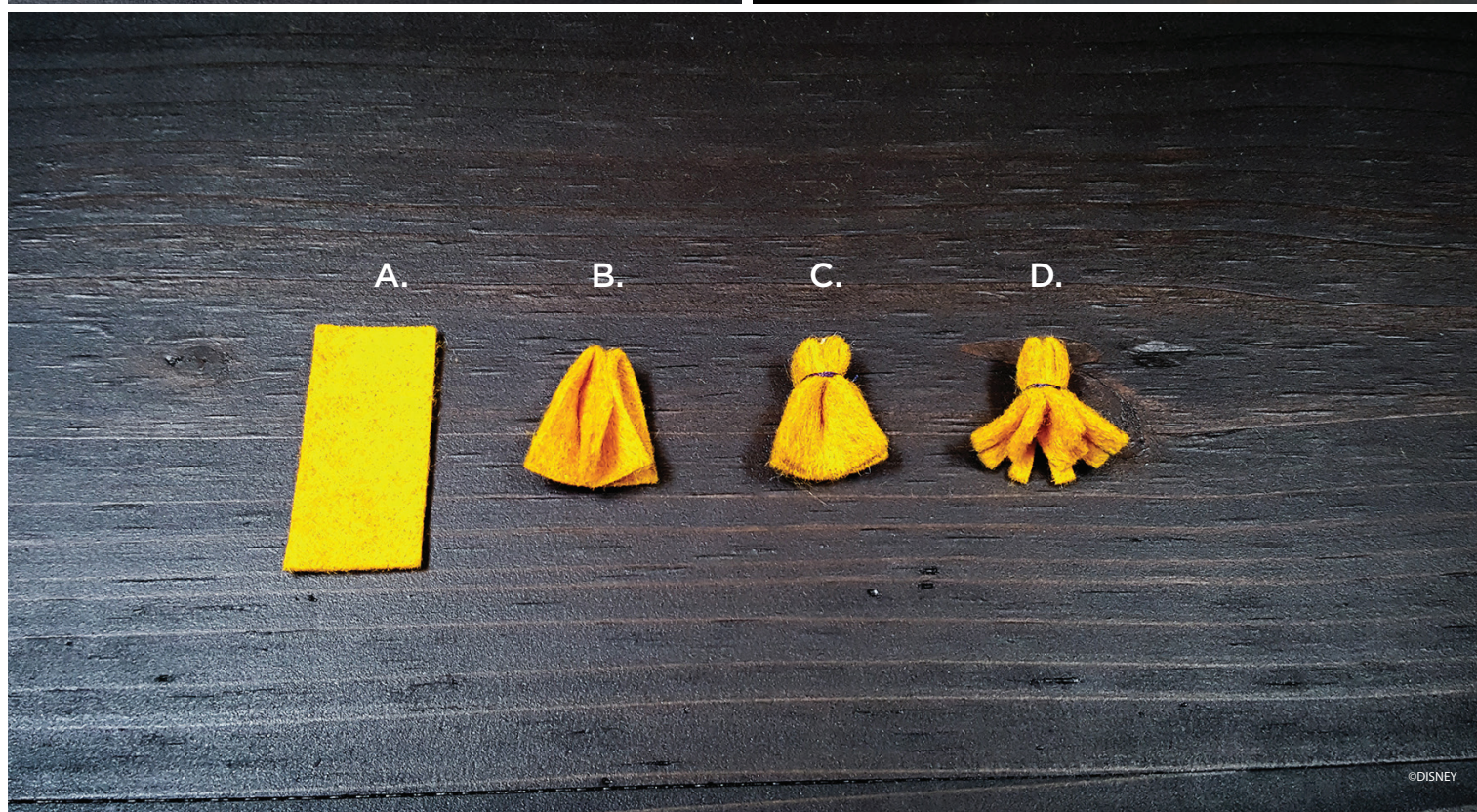
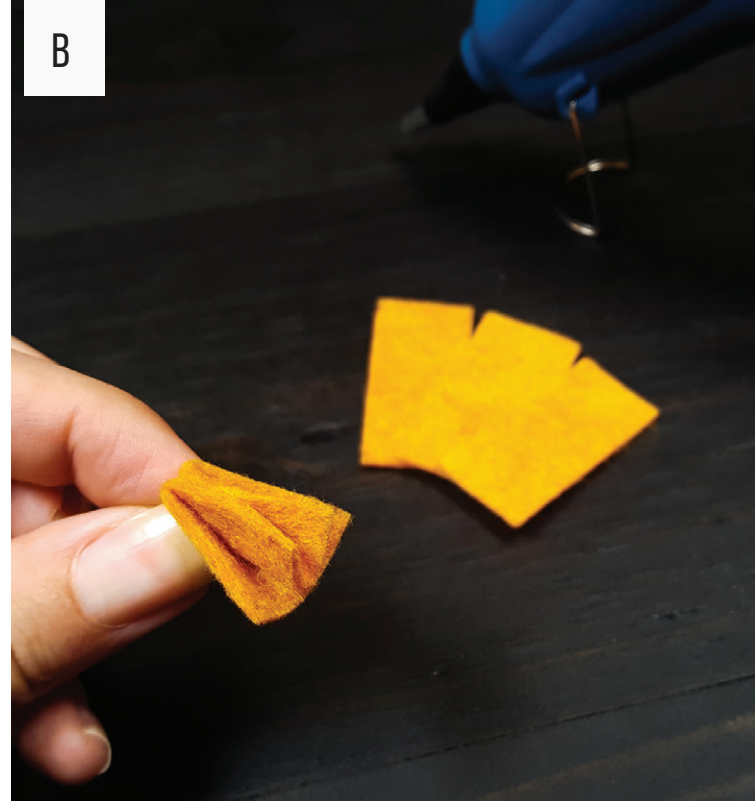
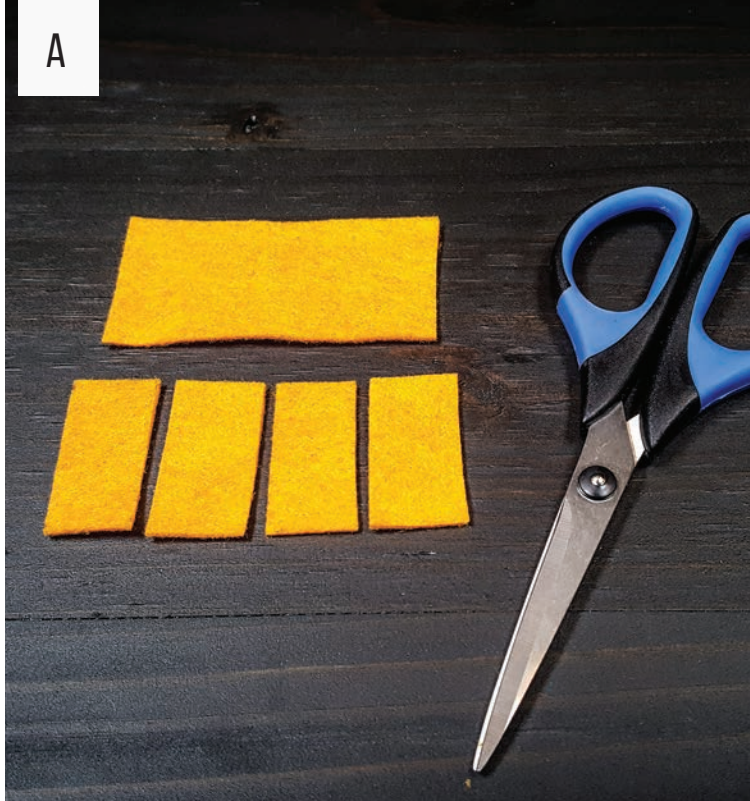





#### Assemble the table:

A. Use hot glue to attach the tablecloth to the top of the wooden base.

B. Take the tea light and cover the sides and top with black tape. Place the tea light underneath the wooden base with the light in the center of the 3/4" hole. Secure with hot glue.

A



B







#### Candles (optional):

A. Paint the dowel rod all white. Cut 6 pieces of various sizes, with the largest being 1.5" tall.

B. Align the bottoms of the three candles together and attach using hot glue. To create a base, pool hot glue along the bottom of the candles on a heat resistant surface. Let cool.

C. Drip glue down the sides.

D. Paint the drips white. Thin out some light brown paint and apply to add age. Cut out flames using the yellow and orange paper and glue to the top.

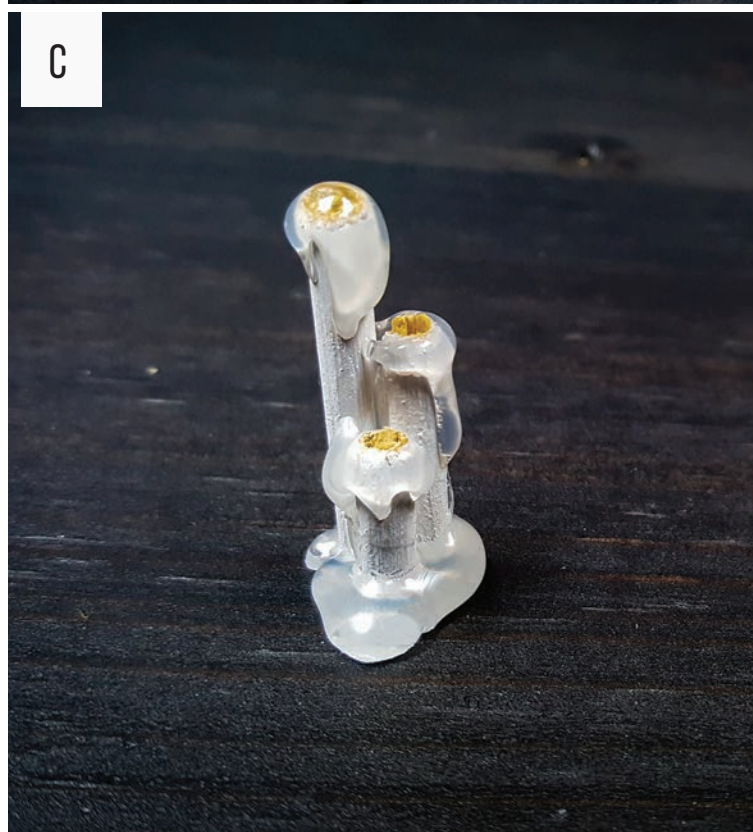
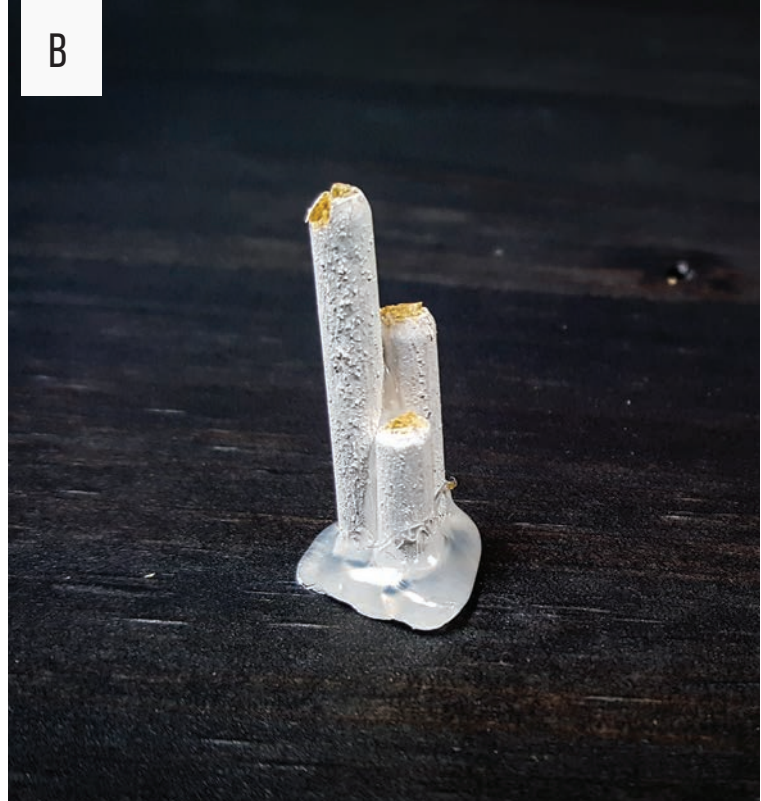
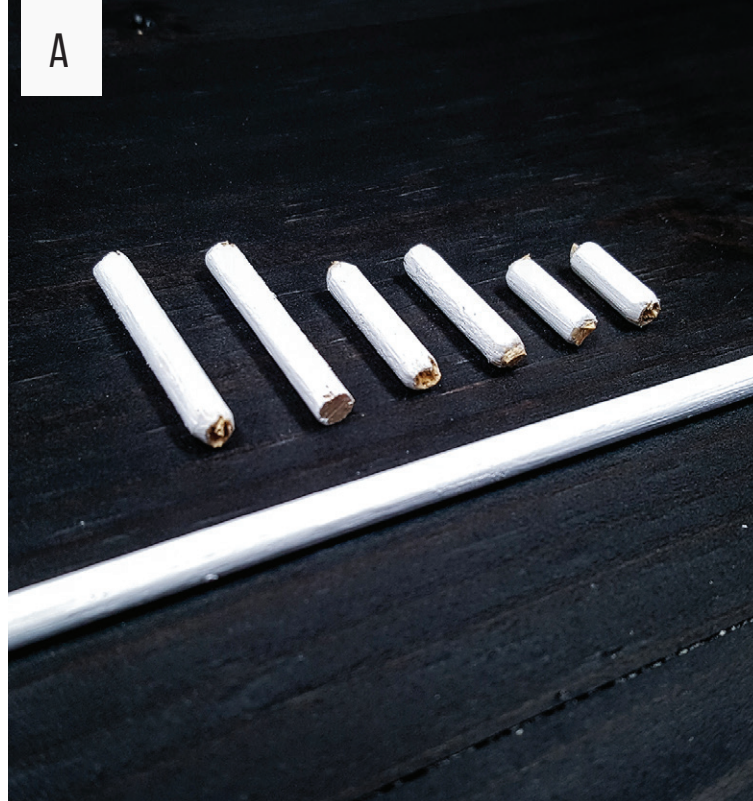





### Paint the crystal ball:

A. Use painter's tape to cover half of your ornament.

B. Spray two coats of the frosted glass spray paint onto the uncovered half of your ornament. Once dry gently lift the edges of the painter's tape, leaving the center of the tape secure.

Hold the spray paint at a slight angle and lightly spray toward the edges of the tape to lightly fade the paint line. Let dry, then remove the tape.



A



B







### Conjure Madame Leota:

**A.** Starting from the side of the template, gently roll the Madame Leota template over a pencil until it wraps around completely, but not too tightly.

**B.** Insert the rolled template into the ornament, tab side down. Slide it off the pencil while still holding the tab.

**C.** While holding the tab, use a pencil or small dowel rod to carefully unroll the template until it is fully open. Use the tab to adjust the angle until it sits center.



A

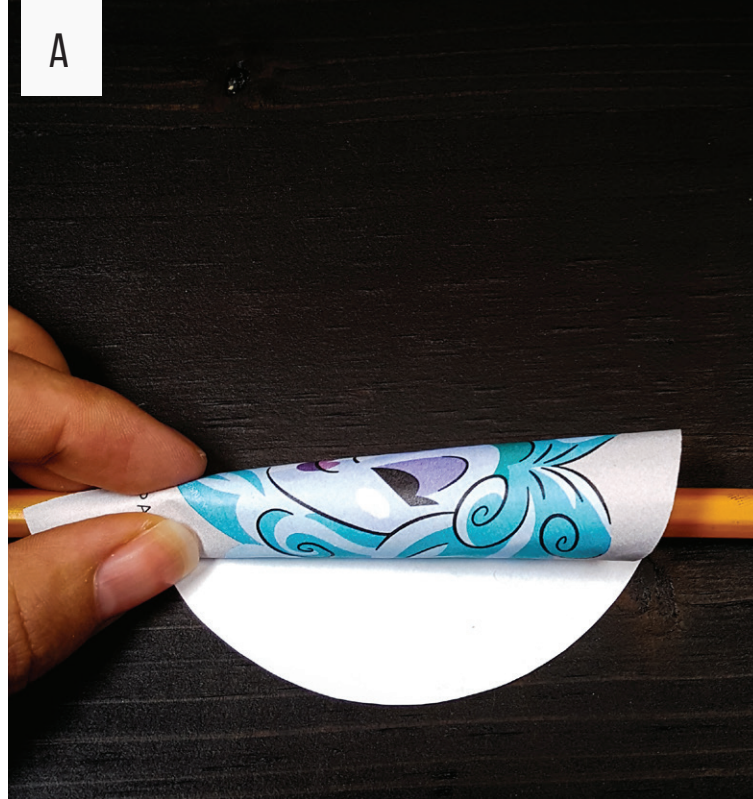

B

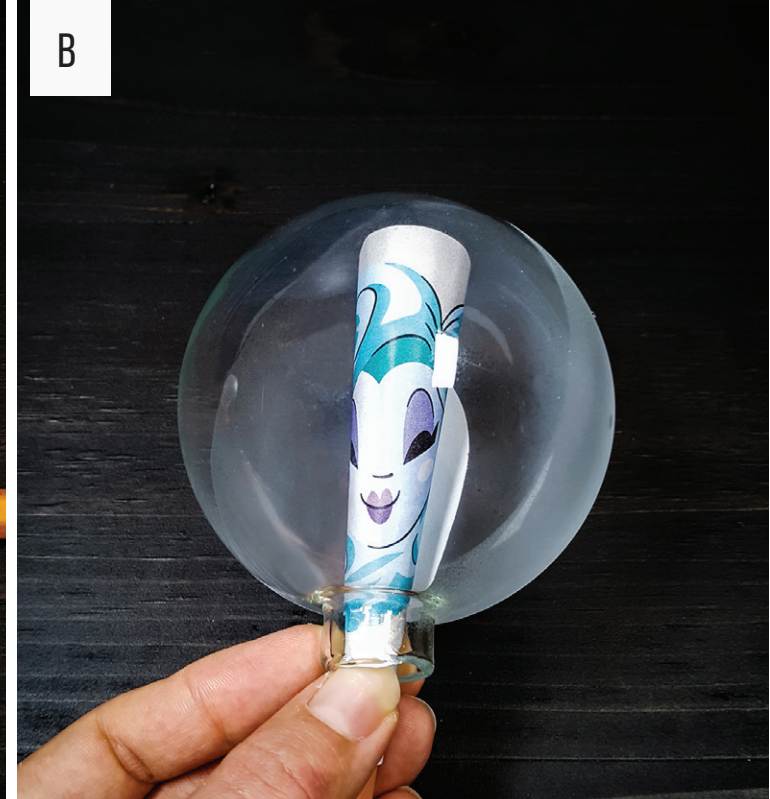

C







#### Attach Leota to the base:

Apply a small amount of hot glue to the tab to secure it to the ornament. Apply some glue to the inside of the hole in the base, then insert the ornament and hold until the glue cools. Glue the candles to the table.

Finally, turn on the LED light and call in the spirits, wherever they're at!

